

**Standard Preparation  
1200 mm Cupboard Sink for  
Dishwasher with 1 Bowl & Left Drainer**

ITEM # \_\_\_\_\_

MODEL # \_\_\_\_\_

NAME # \_\_\_\_\_

SIS # \_\_\_\_\_

AIA # \_\_\_\_\_



132929 (MARMSXN)

\* NOT TRANSLATED \*

### Main Features

- Sturdiness, stability and reliability of table accurately tested.

### Construction

- Inner welded frame in stainless steel to guarantee superior strength and stability.
- 50 mm worktop in 304 AISI stainless steel with upturned edges, incorporates an 18 mm layer of sound deadening material.
- Reinforced side and base panel in 304 AISI stainless steel.
- 304 AISI stainless steel feet, 200 mm high and 54 mm in diameter, adjustable by -50/+30 mm.
- Drainage area suitable for drying operations
- 100 mm upstand with 10 mm radiused corner and 13 mm deep.
- Entirely constructed in stainless steel.
- Bottom part of drain left free to house an undercounter dishwasher.
- Hinged door with sound deadening internal panels, fitted with 304 AISI stainless steel hinges on the inner sides.
- Wide range of taps are available to suit every need.

### Optional Accessories

- - NOT TRANSLATED - PNC 855299 ☐
- Elbow operated mixer tap with PNC 855322 ☐  
spout 3/4", single hole
- Elbow operated mixer tap with PNC 855323 ☐  
short spout 3/4", single hole
- Foot operated mixer tap (hot and cold) with spout 3/4" PNC 855328 ☐
- Single plastic drain syphon 2" PNC 895313 ☐

APPROVAL: \_\_\_\_\_

## Standard Preparation 1200 mm Cupboard Sink for Dishwasher with 1 Bowl & Left Drainer

Front

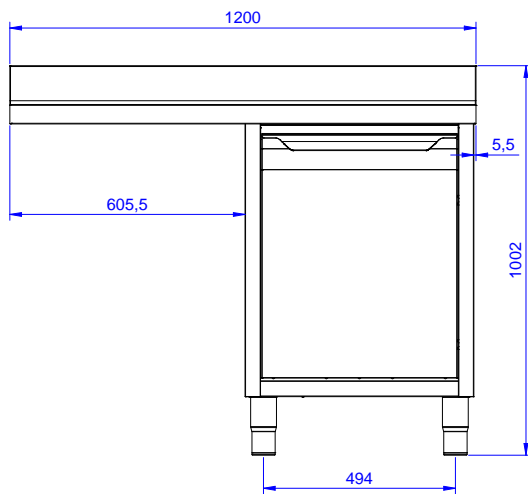

Side

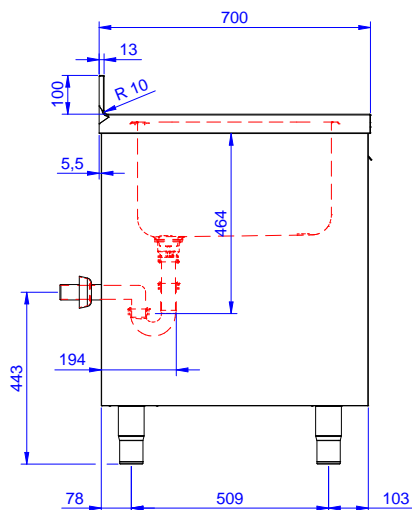

D = Drain

Top

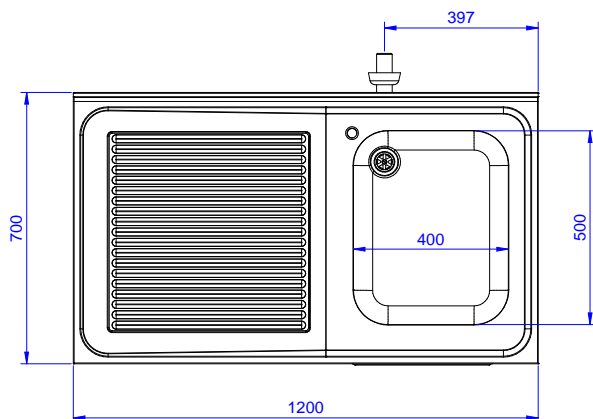

### Drain:

Drainer position: Left

### Key Information:

|                              |              |
|------------------------------|--------------|
| Cabinet width:               | 1145 mm      |
| Cabinet depth:               | 645 mm       |
| Cabinet height:              | 385 mm       |
| External dimensions, Width:  | 1200 mm      |
| External dimensions, Depth:  | 700 mm       |
| External dimensions, Height: | 1000 mm      |
| Upstand Dimensions, Height:  | 100 mm       |
| Upstand Dimensions, Depth:   | 13 mm        |
| Upstand Dimensions, Radius:  | R=10         |
| Bowls number                 | 1            |
| Bowl dimensions              | 400x500xH300 |
| Number and type of doors:    | 1 Hinged     |
| Worktop thickness:           | 50 mm        |
| Net weight:                  | 55 kg        |

Standard Preparation  
1200 mm Cupboard Sink for Dishwasher with 1 Bowl & Left Drainer

The company reserves the right to make modifications to the products without prior notice. All information correct at time of printing.

2025.06.29